

# 4K H.265 Pro NVR 7000 Series



## DATASHEET

<b>4K</b> 4K	<b>H.265 HEVC</b> H.265	<b>Onvif S&amp;T</b> Onvif S&T	<b>N+1 Hot Spare</b> N+1 Hot Spare	<b>Multi-video Output</b>	<b>Transcoding</b>	<b>RAID</b>
<b>ANPR</b> ANPR	<b>VCA</b> VCA	<b>Online Upgrade</b>	<b>P2P</b>	<b>HTML5</b>	<b>ANR</b>	<b>Face Detection</b>

## KEY FEATURES

- ▶ 16/32-CH Network Video Input (Up to 16/32 channel IP cameras can be connected.)
- ▶ H.265<sup>+</sup> (H.265<sup>+</sup> allows to cut down 70%~80% bandwidth while ensuring the high quality of images compared with H.264.)
- ▶ HTML5 Streaming Ready (Support previewing the video via all major browsers without plug-in when Video Codec is set to H.265.)
- ▶ Transcoding (Transcoding guarantees fluid video experience by reducing the stream data via lowering resolution, bit rate, or frame rate.)
- ▶ Versatile Interfaces (A whole array of ports provides all necessary features for effective surveillance.)
- ▶ Auto Backup (The latest 24 hours' video will be automatically backed up to USB Port Devices or NAS after setting up the backup.)

### Power Decoding Capacity & Flexible Storage Options

- The 4K NVR is equipped with solid 4K decoding and display capabilities and maximum supports simultaneous viewing of 16\*1080P or 32\*720P network cameras.
- Providing flexible storage options including HDD and NAS to address the needs for versatile storage.



### Reliability and Usability

- RAID improves the disk reliability to ensure the recording security.
- ANR can store video data on the camera storage card when network between IPC and NVR is disconnected and retransfer the recorded video to NVR after network recovers.
- N+1 Hot Spare can keep the system working on and ensure the data integrity and reliability.

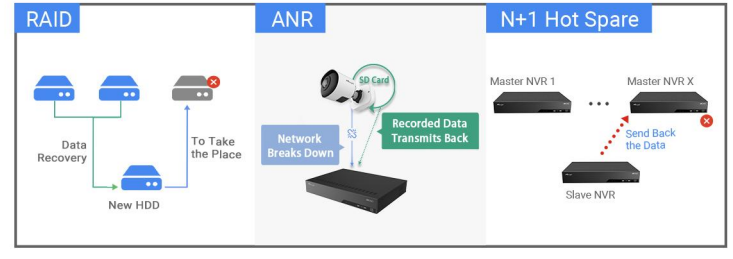

### AI Video Analytics & POS Integration

- All-in-one to Manage AI & ANPR: VCA Function focus on human and vehicle detection. People Counting provides high-accuracy data and statistic reports. Face Detection function supports attribute recognition. Enterprise ANPR Management makes it easy to monitor traffic.
- POS machine information can be transferred to and displayed on the NVR.

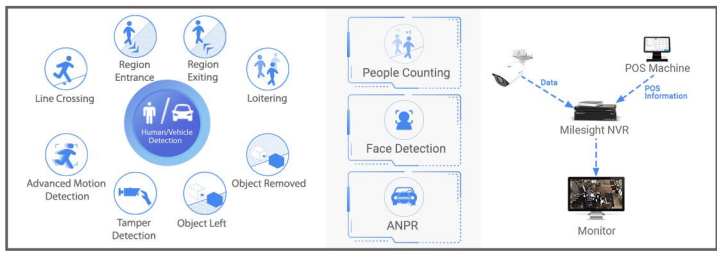

### Flexible Structure Options

- Multi-video Output in two ways: Independent Outputs and Synchronous Outputs
- Dual network ports provide three network working modes for more independence, and higher throughput and stability according to the specific applications and needs.

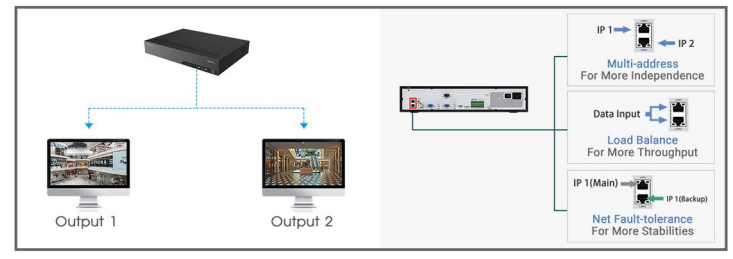



Model		MS-N7016-UH	MS-N7032-UH	
Video/Audio Input	Network Video Input	16-CH	32-CH	
	Bandwidth	Incoming	160Mbps	256Mbps or 200Mbps(when RAID is enabled)
		Outgoing	160Mbps	256Mbps or 200Mbps(when RAID is enabled)
Video/Audio Output	HDMI Output	1-CH, Resolution: 3840x2160/60Hz, 3840x2160/30Hz, 1920x1080/60Hz, 1920x1080/50Hz, 1280x1024/60Hz, 1280x720/60Hz, 1024x768/60Hz HDMI Supports Audio Output		
	VGA Output	1-CH, Resolution: 1920x1080/60Hz, 1920x1080/50Hz, 1280x1024/60Hz, 1280x720/60Hz, 1024x768/60Hz		
	Dual Stream	Support		
	Recording Resolution	12MP/8MP/6MP/5MP/4MP/3MP/1080P/UXGA/720P/D1/VGA/CIF/QCIF		
	Synchronous Playback	4*(30fps @8MP), 5*(30fps @6MP), 6*(30fps @5MP), 8*(30fps @4MP), 10*(30fps @3MP), 16*(30fps @1080P), 16*(30fps @720P)	4*(30fps @8MP), 5*(30fps @6MP), 6*(30fps @5MP), 8*(30fps @4MP), 10*(30fps @3MP), 16*(30fps @1080P), 32*(30fps @720P)	
Video/Audio Compression	Video Compression	H.265+/H.265(HEVC)/H.264+/H.264		
	Audio Compression	G.711/AAC/G.722/G.726		
	Sample Rate	8KHz/16KHz		
Storage	SATA	4*SATA HDD(3.5")		
	Capacity	Up to 10TB capacity for each HDD		
Disk Array	Array Type	RAID0, RAID1, RAID5, RAID6, RAID10		
Recording Management	Recording Type	Continuous, Event (Motion Detection, Alarm, VCA, Smart Analysis)		
	Snapshot Type	Continuous, Event (Motion Detection, Alarm, VCA, Smart Analysis)		
	Playback Type	General Playback, Event Playback, Tag Playback, Split Playback, Picture Playback		
Backup	Backup	Video Backup, Image Backup		
Network	Protocol	IPv4/IPv6, TCP, UDP, RTP, RTSP, RTCP, HTTP, HTTPS, DNS, DDNS, DHCP, NTP, SNTP, SMTP, SNMP, UPnP, NFS		
External Interface	Network Interface	2*RJ45 10/100/1000Mbps 1*RS-485 Series Port for PTZ		
	Serial Interface	1*RS-232 Series Port for Console		
		1*RS-485 Series Port for Keyboard		
	USB Interface	1*USB 3.0; 2*USB 2.0		
	Audio Input/Output	1*RCA/1*RCA		
	Alarm Input/Output	16-CH/4-CH		
General	Compatibility	ONVIF, API		
	Advanced Function	ANR, N+1 Hot Spare		
	ANPR	Support		
	Video Analysis	Region Entrance, Region Exiting, Advanced Motion Detection, Tamper Detection, Line Crossing, Loitering, Human Detection, People Counting, Object Left, Object Removed		
	Keyboard Control	Milesight Keyboard (MS-K01)		
	Power Supply	AC 100V~240V 50Hz~60Hz		
	Consumption	≤15W(Without HDD)		
	Working Conditions	Temperature: -10℃~55℃/Humidity: 10%~90%		
	Dimensions	Rack Mountable Chassis (1.5U Standard) 440mm(W)X320mm(D)X66.8mm(H)		
	Weight	4.1Kg		
	Warranty	3/5 Years		

# 4K H.265 Pro NVR 7000 Series



## Interfaces

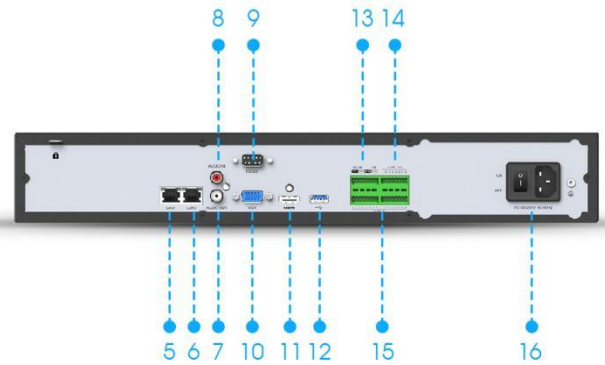

- 1. Run Indicator    2. HDD Indicator    3. USB    4. Power Light
- 5. LAN1    6. LAN2    7. Audio Out    8. Audio In
- 9. RS-232    10. VGA    11. HDMI    12. USB    13. RS-485    14. Alarm Out    15. Alarm In    16. Power

## Installation of HDDs



## Structure Diagrams

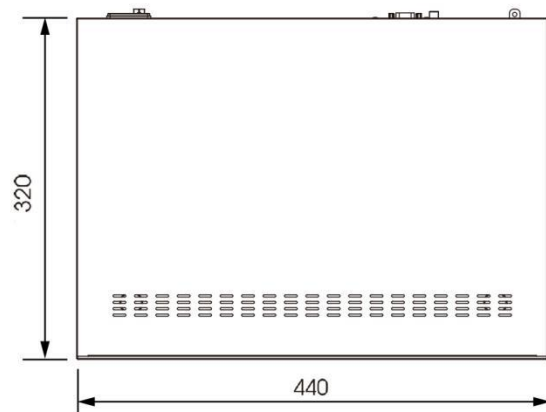

Units: mm

## Naming Convention

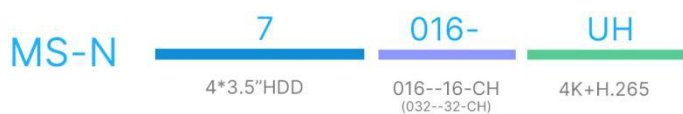

**Milesight Technology** | [www.milesight.com](http://www.milesight.com)  
 Contact Us: [sales@milesight.com](mailto:sales@milesight.com) | [support@milesight.com](mailto:support@milesight.com)

Add: 220 NE 51st Street, Oakland Park, Florida 33334, USA  
 Tel: +1-800-561-0485

Add: 925, Anyang SK V1 Center, LS-ro 116beon-gil, Dongan-gu, Anvang-si, Korea  
 Tel: +82-31-990-7732

Add: Building C09, Software Park Phase III, Xiamen 361024, Fujian, China  
 Tel: +86-592-5922772

